

Guide Sets & Mold Counters

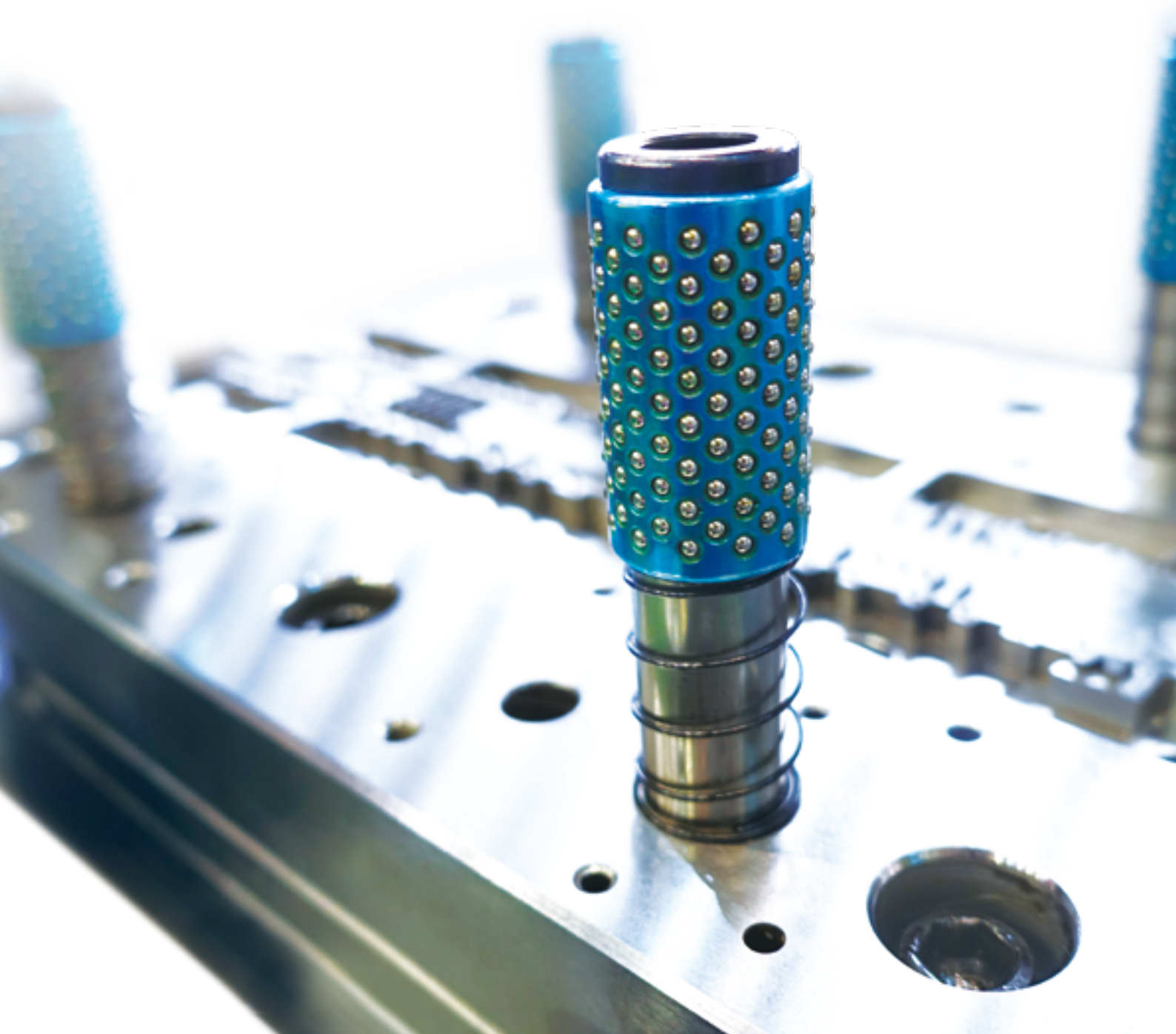

Made in Taiwan

Guide Sets

For your press molds
Gaurantee your molds working
in high precision and high speed



35 years OEM experience
since 1978

$\pm 0.5\mu\text{m}$ tolerance control ability
for guide post and bushes

ISO 9001 certified

Customized and small quantity
production available

For Press Molds

AMS PMS

Aluminum ball retainers
POM ball retainers

Retainer Material : AMS Aluminum
PMS POM

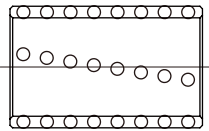

Type	PD	L						D2	d
AMS PMS	19	60						24.4	3.0
	20	50	60					25.4	
	22	50	60					27.4	
	25	50	60	75			30.4	4.0	
	28			75			35.4		
	30	60		75			90		37.4
	32	60					90	39.4	
	36			80		90	43.4	5.0	
	38			70	90		47.4		
	40					90	49.4		
	45					90	110	54.4	
	50					90	110	59.4	
60					90	100	110	69.4	

ACS PCS

Aluminum ball retainers
POM ball retainers

Retainer Material : ACS Aluminum
PCS POM

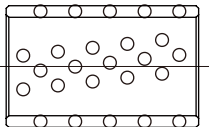

Type	PD	L						D2	d
ACS PCS	19	50 60						24.4	3.0
	20	30	35	40	45	50	60	25.4	
	22			50		60	27.4		
	25			40	45	50	60	75	30.4
	28					60	75	33.4	
	32					60	75	90	39.4
	38					70	85	90	47.4
	45					75	110	54.4	
	50					90	110	59.4	
	60					100	110	69.4	

LDA LDO

Aluminum ball retainers
POM ball retainers

Retainer Material : LDA Aluminum
LDO POM

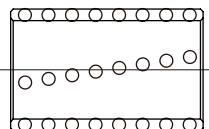

Type	PD	L				D2	d	
LDA LDO	10	25	30	35		13.7	2.0	
	13	25	30	35		16.7		
	16	25	30	35	40	19.7		
	20	25	30	35		25.4	3.0	
	20				40	45		30.4
	25				40	45		30.4

RDA RDO

Aluminum ball retainers
POM ball retainers

Retainer Material : RDA Aluminum
RDO POM

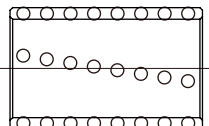

Type	PD	L	D2	d
RDA RDO	19	60	24.4	3.0
	20		25.4	
	22		27.4	
	24	75	29.4	4.0
	25		30.4	
	28		33.4	
	31	85	38.4	5.0
	32		39.4	
	36		43.4	
	37	95	46.4	5.0
	38		47.4	
	40		49.4	
	45		54.4	
	50		59.4	
	56	106	65.4	

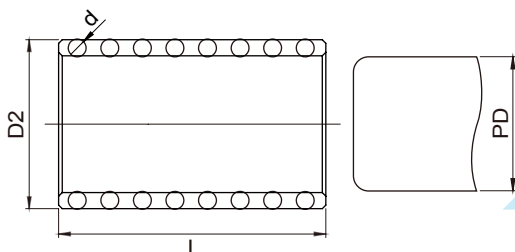

Customized Production is Available

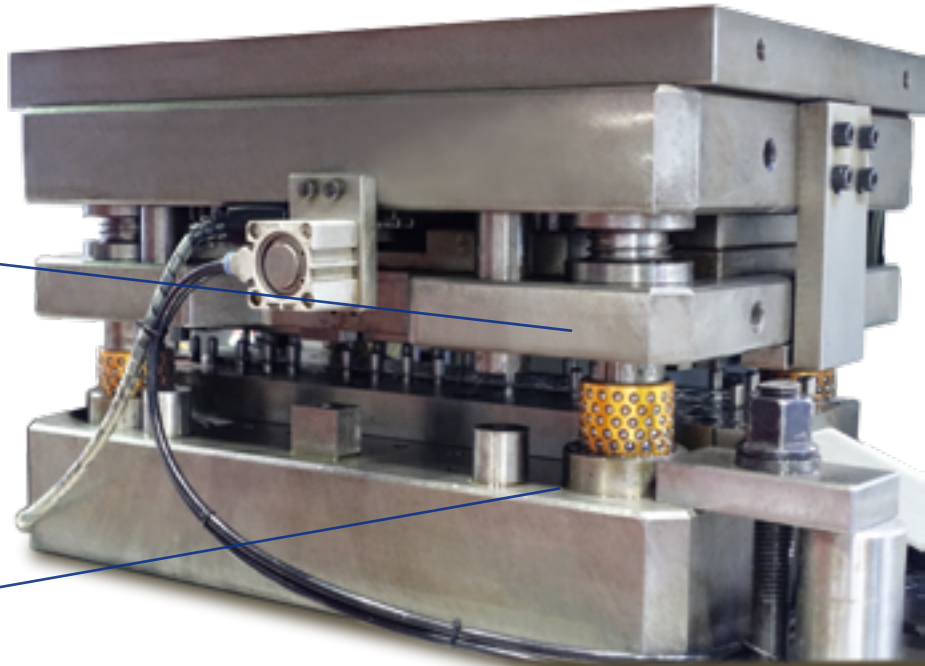
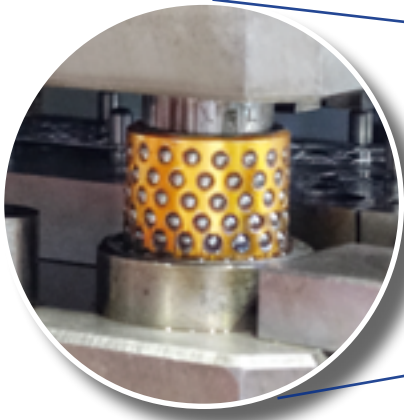

BA2S BP2S

Double spiral ball retainers

Retainer Material : BA2S Aluminum
BP2S POM

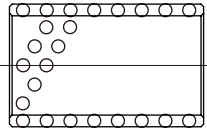

Type	PD	L										D2	d	
BA2S BP2S	10			25	30							13.7	2.0	
	13	15	20	25	30	40						16.7		
	16			25	30	40						19.7		
	19						45	50					24.4	3.0
	20				30	40	45	50					25.4	
	22							50	60				27.4	
	25					40	45	50	60	75			30.4	4.0
	28								60	75			35.4	
	32									75	90		39.4	
	38										90	110	47.4	5.0
	45										90	110	54.4	
	50										90	110	59.4	
	60										90	110	69.4	6.0
	70											120	81.4	
	75											120	86.4	

BA2T BP2T

Double track ball retainers

Retainer Material : BA2T Aluminum
BP2T POM

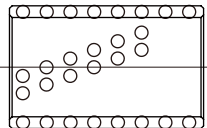

Type	PD	L										D2	d	
BA2T BP2T	10			25	30							13.7	2.0	
	13	15	20	25	30	40						16.7		
	16			25	30	40						19.7		
	19						45	50					24.4	3.0
	20				30	40	45	50					25.4	
	22							50	60				27.4	
	25					40	45	50	60	75			30.4	4.0
	28								60	75			35.4	
	32									75	90		39.4	
	38										90	110	47.4	5.0
	45										90	110	54.4	
	50										90	110	59.4	
	60										90	110	69.4	6.0
	70											120	81.4	
	75											120	86.4	

7611

Aluminum ball retainers with anti-dust unit

Retainer Material : Aluminum

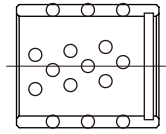

Type	PD	L																D2	d								
7611	12	20		28		36			42							51								15.7	2.0		
	15					35			42							52								65		20.4	
	16		24		30	35	37	39	42	47						52								65		21.4	
	19					35	37			43	47	50				57	65							82		24.4	
	20					35	37			43	50				56	57								72	82		25.4
	24									43	50					60	67	77						84	100	108	29.4
	25									43						52		60	67	77				84	100	108	30.4

Type	PD	L																D2	d									
7611	30	52			65	74	80																			37.4		
	32	52			65	74	80				90	100														121	39.4	
	38			60							85	100															45.4	
	40		55	60	65		75	80	85			100		115											125	134	150	47.4
	48					67			82			94	100	110											125	136		55.4
	50					67			82			94	100	110											125	136	147	59.4
	63															100										125		70.4

7631

Brass ball retainers with circuit clip

Retainer Material : Brass

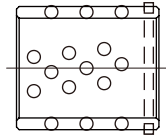

Type	PD	L																D2	d										
7631	12	20		28		36	42									51											15.7	2.0	
	15		24		35											52												20.4	
	16		24		35		42									52									65	72		21.4	
	19				35				43	50						57	65									82		24.4	
	20				35					50						57										72	82		25.4
	24								43						52		60	67	77							84		29.4	
	25								43						52		60	67	77							84	100	30.4	

Type	PD	L																D2	d											
7631	30		52		65	74	80																				121	37.4		
	32		52		65	74	80				90	100															121	39.4		
	40			60	65		75				85	100		115													134		47.4	
	48					67			82			94	100	110												125	136		55.4	
	50	50				67			82			94	100	110												125	136	147	58.4	
	63																									125		155	167	70.4

BA2SR

Double spiral aluminum ball retainers with anti-dust unit

Retainer Material : Aluminum

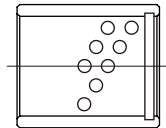

Type	PD	L																D2	d													
BA2SR	12	20		28		36										42											51				15.7	2.0
	15					35										42											52	65		20.4		
	16		24	28	30	35	36	37								42	47										52	65		21.4		
	19			28		35	36	37								42	43	47	50								57	65	82	24.4	3.0	
	20					35										38	43	50									57	65	72	82	25.4	
	22																										47				27.4	

BC2SR

Double spiral brass ball retainers with anti-dust unit

Retainer Material : Brass

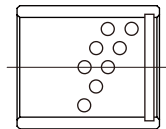

Type	PD	L																D2	d													
BC2SR	16		20		28											36															19.7	2.0
	19																										42	51		19.7		
	19															35														24.4	3.0	

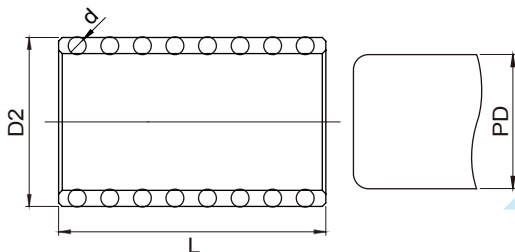

Customized Production is Available

For Plastic Injection Molds

EMBSS

Ball retainers

Retainer Material : Brass

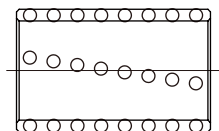

Type	PD	L					D2					d
EMBSS	6						15					1.0
	8	10					15					

EMBS

Brass ball sliders
for Ejector Bushings

Retainer Material : Brass

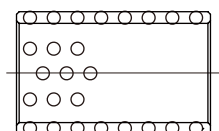

Type	PD	L										D2	d
EMBS	8	25	30	35	40							11.7	2.0
	10	25	30	35	40							13.7	
	13			35	40	45	50	55	60	65	70	16.7	
	16			35	40	45	50	55	60	65	70	19.7	
	20			35	40	45	50	55	60	65	70	23.7	
	25			35	40	45	50	55	60	65	70	28.7	
	30			35	40	45	50	55	60	65	70	33.7	

EGBTR

Brass ball retainers
with circuit clip

Retainer Material : Brass

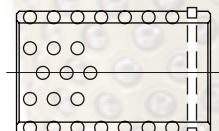

Type	PD	L					D2					d	
EGBTR	10	30		40								13.7	2.0
	13			40			50					16.7	
	16			40			50					19.7	
	20						50		60			25.4	3.0
	25						50		60		70	30.4	

Machine Tool Components

WFLK

Brass ball retainers
for tapping chuck

Retainer Material : Brass

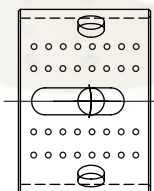

Type	PD	L		D2	d
WFLK-124	24	20		27.3	1.5
WFLK-224	38	36		40.8	
WFLK-324	57	57		60.6	2.0
WFLK-424	72	60		75.6	

Automation Components

BGS

Miniature Brass Ball Sliders

Retainer Material : Brass

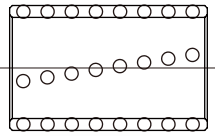

Type	PD	L					D2	d	
BGS	3	10	15		20		4.8	1.0	
	4	10	15		20		5.8		
	5	10	15		20		6.8		
	6		15		20	30	7.8		
	7			17	20		8.8		
	8		15		20	30	9.8		
	10	10			20	30	40		11.8
	12				20	30	40		13.8

BYS

Miniature Brass Ball Sliders

Retainer Material : Brass



Type	PD	L				D2	d
BYS	2	10	15	20		3.1	0.6
	3	10	15	20		4.1	
	4	10	15	20		5.1	
	5	10	15	20		6.1	
	6		15	20	30	7.1	
	8		15	20	30	9.1	

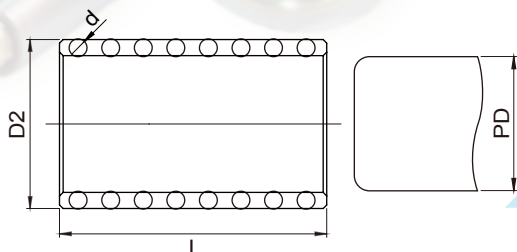
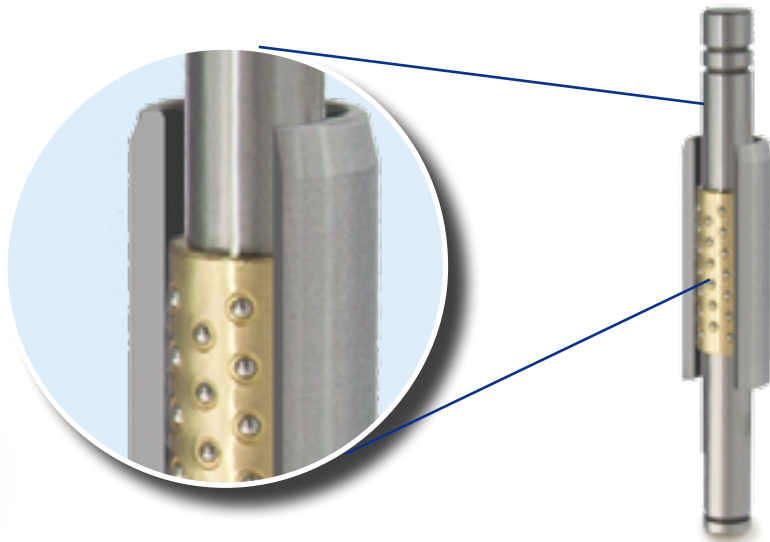

Customized Production is Available

Customized Post & Bush

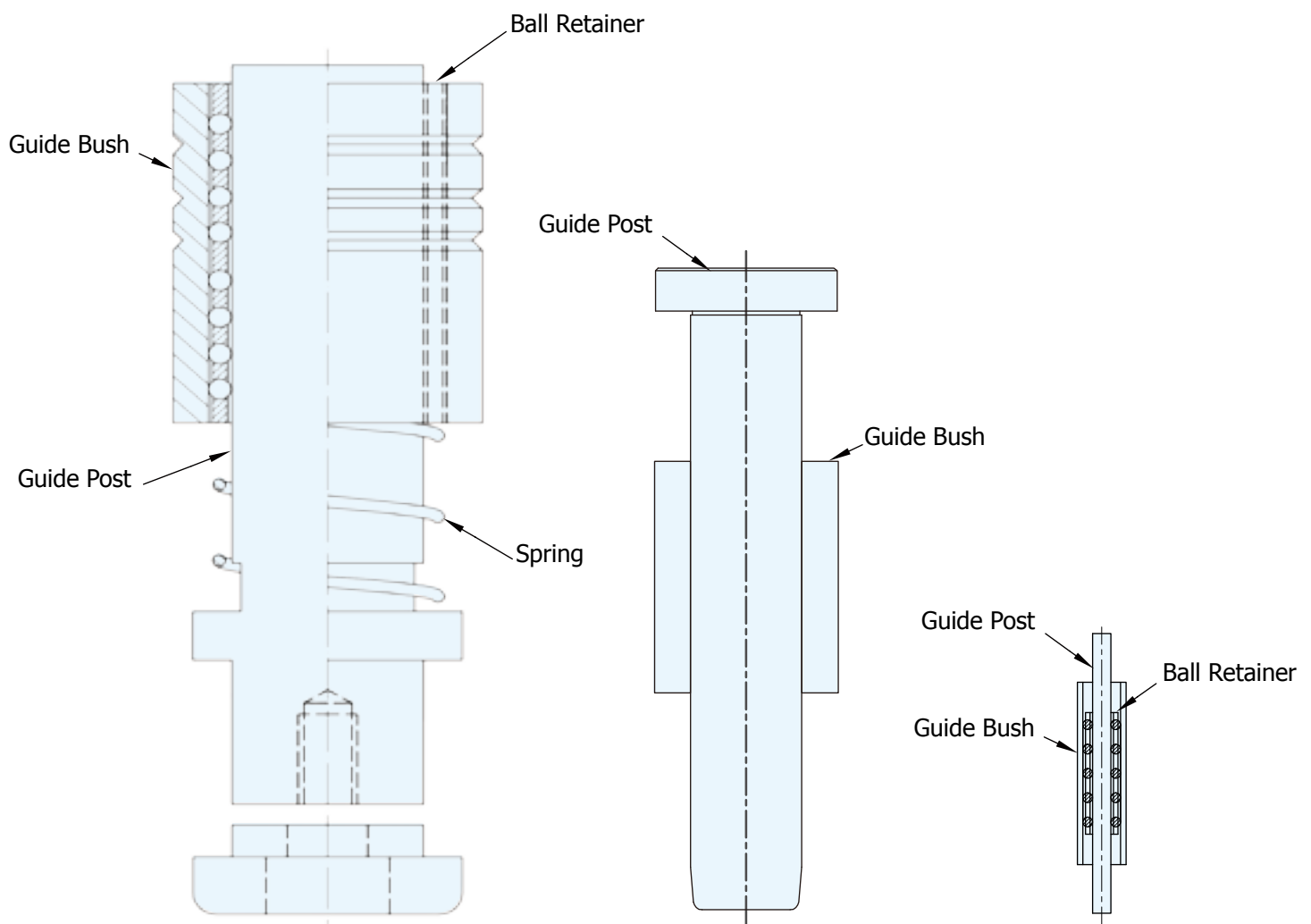

Customized Production is Available

Mold Counter

For your injection molds
Monitor the usage of your mold
Gaurantee your right in a contract production

Before (0000000)



After (0000001)



**Germany, Taiwan and China
patented**

**7 digits and 6 digits
for different usage of molds**

2 million times warranty

**Highest temperature endurable
160°C/320°F**

**Serial number and tamper sticker
for each counter**

3 Workdays

MRSP-7

Temperature 120°C
7-digits

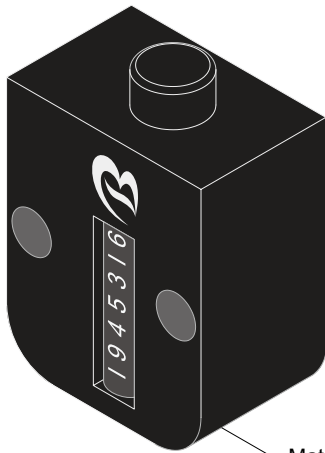

Material
Nylon+Fiber Glass

MRSP2-7

Temperature 160°C
7-digits

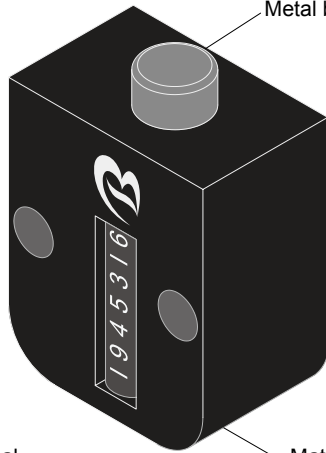

Material
Nylon+Fiber Glass

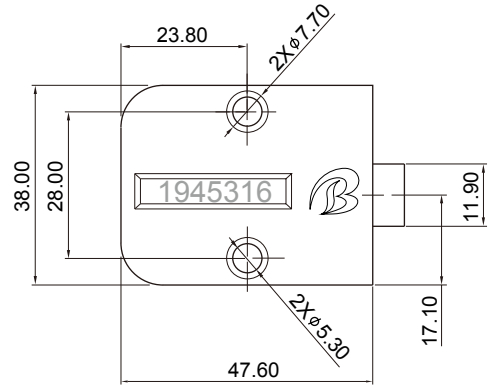

External Mount

No Pocket Maching Necessary

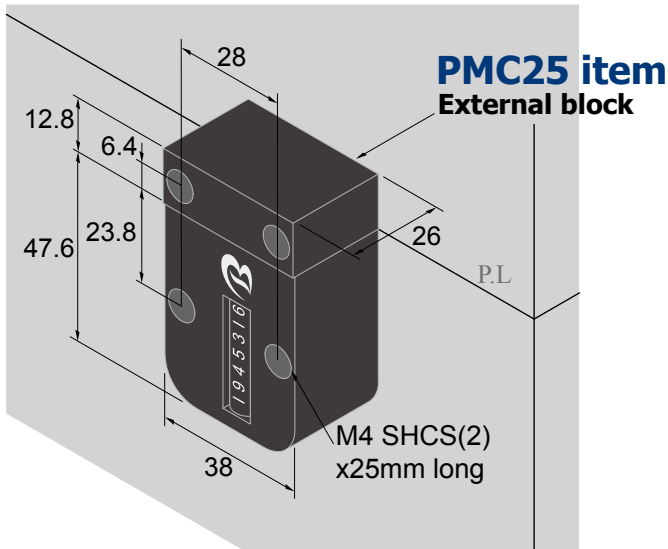

Embedded Mount

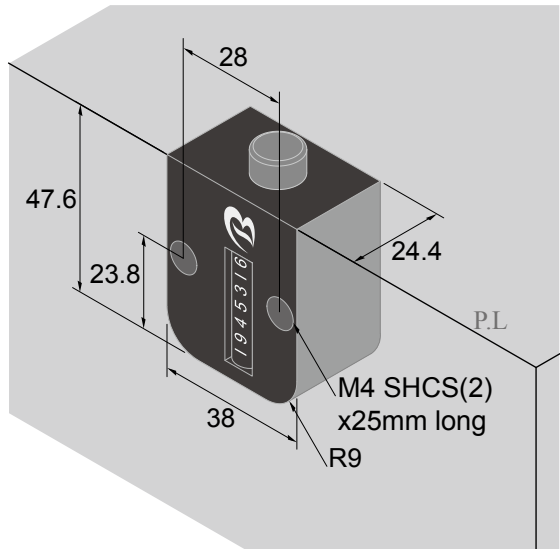

Material : Block:Blackening S45C

MRSP-7 x1 + PMC25 x1

3 Workdays

BMCS-6

Temperature 120°C
6-digits
Square shape

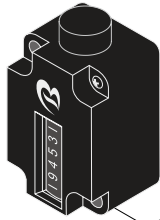

Material
Nylon+Fiber Glass

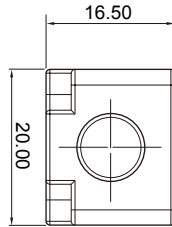
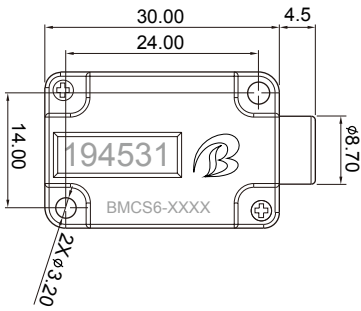

BMCR-6

Temperature 120°C
6-digits
Round shape



Material
Nylon+Fiber Glass

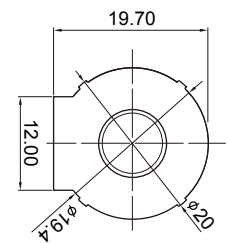
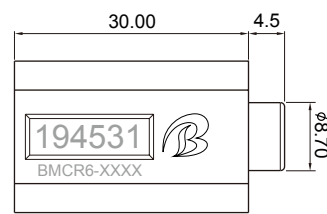

160°C test report



Temperature Resistance		
Test Equipment :		
Name	Brand	Model
OVEN	CHUNG CHUAN	DH-600
Lab Environmental Conditions :		
Ambient temperature :	23±2°C	
Relative humidity :	65±5%RH	
Test Condition :		
Test Temperature :	160 °C	
Test Time :	30 minutes	
Test Result :		
Test Item(s)	Test Result(s)	
Temperature Resistance	The sample can calculate after test.	

Patented



Germany Patent #202011001185.2



China Patent #201020148872.X



Taiwan Patent #M381961



T-sense[®]
TSENSE TECHNOLOGY CO.,LTD
得盛世企業

6F.,No.100,Jian 1st Rd.,Zhonghe Dist.,New Taipei City 235,Taiwan(R.O.C)

TEL:+886-2-77298471 FAX:+886-2-22235743

E-mail:tsense@tsense-tw.com <http://en.toolsetter.tw>