

鑽石切片 / Plated Diamond Disc

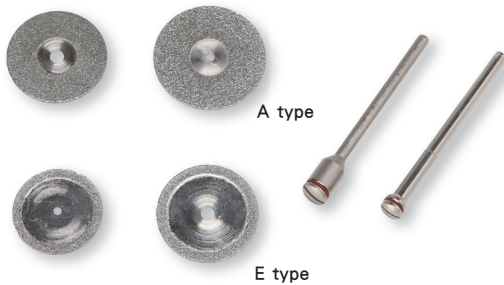

鑽石切片適用於切溝、切斷，研磨下列材質：玻璃、鋁鋼、陶瓷、石材、硬橡膠、FRP、碳纖維、石墨以及複合材料，...等。

Diamond disc use for grooving, cutting, & grinding the following materials: glass, tungsten carbide, ceramic, stone, hard rubber, FRP, composite materials and graphite...etc.

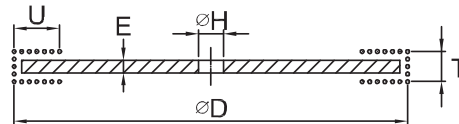

Order no.	Type	ØD	T	U	E	ØH	Grit	Mandrel
編號		(mm)	(mm)	(mm)	(mm)	(mm)	粒度	軸柄
BM-190E	E	19	0.4	2	0.2	1.7	#200	A,B,C
BM-190A	A	19	0.4	6	0.2	1.7	#200	A,B,C
BM-220E	E	22	0.4	2	0.2	1.7	#200	A,B,C
BM-220A	A	22	0.4	8	0.2	1.7	#200	A,B,C
BM-250E	E	25	0.4	2	0.2	1.7	#200	A,B,C
BM-250A	A	25	0.5	8	0.2	1.7	#150	A,B,C
BM-300E	E	30	0.4	2	0.2	1.7	#200	A,B,C
BM-300A	A	30	0.5	8	0.2	1.7	#150	A,B,C
BM-221E	E	22	0.4	2	0.2	3.0	#200	D,E,F
BM-221A	A	22	0.4	8	0.2	3.0	#200	D,E,F
BM-251E	E	25	0.4	2	0.2	3.0	#200	D,E,F
BM-251A	A	25	0.5	8	0.2	3.0	#150	D,E,F
BM-301E	E	30	0.4	2	0.2	3.0	#200	D,E,F
BM-301A	A	30	0.5	10	0.2	3.0	#150	D,E,F

軸柄/Mandrel :

Order no.	ØD	Ød	Order no.	ØD	Ød
A. AK234	2.34	1.7	D. MK234	2.34	3.0
B. AK300	3.0	1.7	E. MK300	3.0	3.0
C. AK318	3.175	1.7	F. MK318	3.175	3.0

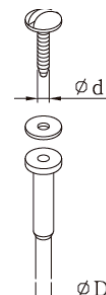



電鑄鑽石鑽管 / Electroplated Diamond Core Drills



■ 此系列產品主要使用於FRP、超硬磁磚、人造花崗岩、花崗岩、拋光石英磚、瓷器、大理石、陶器、赤土陶器、玻璃、石墨、石材等材料之鑽孔。

■ **Electroplated Diamond Core Drills** are used for drilling FRP, hard tiles, artificial granite, granite, quartz, porcelain, marble, ceramic, terra cotta ceramic, glass, graphite, & stone.

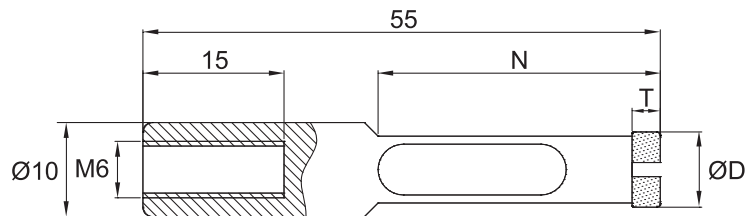

規格 / Specifications:

單位 / Unit : mm

編號 Order no.	ØD		T	N	粒度 Grit size	備註 Note
	mm	inch				
ESD-032	3.2	1/8"	10	25	#60	Solid drills
ECD-050	5.0	3/16"	3	30	#60	Core Drills
ECD-065	6.5	1/4"	3	30	#60	Core Drills
ECD-080	8	5/16"	3	30	#60	Core Drills
ECD-100	10	3/8"	3	30	#60	Core Drills
ECD-130	13	1/2"	3	30	#60	Core Drills
ECD-160	16	5/8"	3	35	#60	Core Drills
ECD-191	19.05	3/4"	3	35	#60	Core Drills
ECD-254	25.4	1"	3	35	#60	Core Drills

■ 標準粒度外，其他粒度請指明訂購。

■ Grit size in the above table is standard for that item, others are available upon request.

電鑄鑽石鋸片 / Electroplated Diamond Cutters

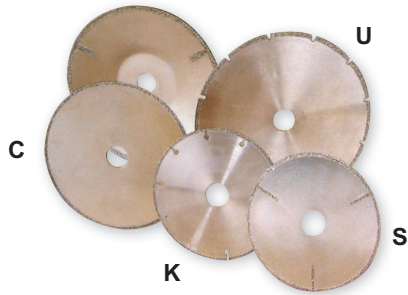

■ 此系列產品主要使用於大理石、磁磚、FRP、碳纖或石墨等之切割。

■ **Electroplated Diamond Cutters** are used for cutting marble, tile, FRP., carbon or graphics.

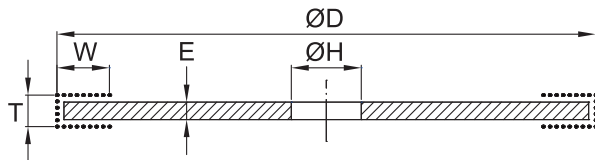

C: 連續式 / Continuous rim type

S: 幅條式 / Spoke type

U: U 溝式 / U-slot type

K: 水滴溝式 / Key hole slot type

規格 / Specifications:

單位 / Unit : mm

編號 Order no.	øD	E	T	W	型式 Type	øH	粒度 Grit size
SP-05008	50	0.8	1.8	2~3	C,S,U	Depend on your request 訂購時，敬請指明。	#40
SP-06308	63	0.8	1.8	2~3	C,S,U		#40
SP-10008	100	0.8	1.8	2~3	C,S,U		#40
SP-11508	115	0.8	1.8	2~3	C,S,U		#40
SP-11510K	115	1.0	2.0	2~3	K		#40
SP-12508	125	0.8	1.8	2~3	C,S,U		#40
SP-15008	150	0.8	1.8	2~3	C,S,U		#40
SP-15012	150	1.2	2.2	2~3	C,S,U		#40
SP-17512	175	1.2	2.2	2~3	C,S,U		#40
SP-20012	200	1.2	2.2	2~3	C,S,U		#40
SP-25012	250	1.2	2.2	2~3	C,S,U		#40
SP-30012	300	1.2	2.2	2~3	C,S,U		#40

■ 標準粒度外，其他粒度請指明訂購。

■ Grit size in the above table is standard for that item, others are available upon request.