

4 *Corners*
Double-Sided
共可使用 4 刃

超快桿



BNMX 超越快的極限

高效率

高壽命

可雙面使用

產品特色 Features

- 1 加工深度最高可達到 1mm。
Productivity- High feed rates with axial depth of cut up to 1mm.
- 2 高進給銑削增加切屑排出量，提高生產力。
High Feed Milling- Increase chip removal capability and productivity.
- 3 低切削阻力和優異的抗震性能，實現高效率加工。
Low cutting resistance and outstanding anti-vibration for high efficiency milling.
- 4 搭載台灣自製低摩擦係數刀片，實現優異的排屑性能。
Taiwan self-made low friction coefficient inserts feature excellent chip disposal.
- 5 提供刃徑尺寸 $\phi 16\sim 100\text{mm}$ ，適合各種零組件 & 高硬模具高進給加工。
Diameter $16\sim 100\text{mm}$ are offered, for all components and mold high feed machining.







Performance Test

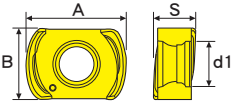

BNMX高進給型銑刀片

HIGH EFFICIENCY & HIGH FEED MILLING INSERT

鎢鋼銑刀片 CARBIDE INSERT SIZE

加工材質	P	鋼材 Alloy Steels	◎	◎	◎	◎	◎	◎：第一推薦 First Recommend ○：第二推薦 Second Recommend -：不推薦 NO Recommend					
	M	不銹鋼 Stainless Steels	◎	◎	◎	◎	◎	F：精加工 Finishing S：半精加工 Semi Finishing M：中加工 Medium R：粗加工 Roughing					
	K	鑄鐵 Cast Iron	◎	◎	◎	◎	◎						
	N	鋁合金 Aluminum Alloys	-	-	-	-	-						
	S	高溫合金 High Temp Alloys	○	◎	○	◎	◎						
	H	調質鋼 Hardened Steels	◎	◎	○	◎	-						
刀片 Insert	訂購編號 Order No.	材質碼 Grade					尺寸 Dimension (mm)					刀片 2D 圖 Drawing	
		CM6322	CM6223	CM6332	CM6233	CM6243	A	B	S	r	d1		
	T	BNMX0603-SG	●	●	●	●	●	9.00	6.38	3.75	-	3.20	
F	S	M	R										
	T	BNMX0603-MG	●	●	●	●	●	9.00	6.38	3.75	-	3.20	
F	S	M	R										
	T	BNMX0603-RG	●	●	●	●	●	9.00	6.38	3.75	-	3.20	
F	S	M	R										
	T	BNMX0904-MG	●	●	●	●	●	11.9	9.18	4.80	-	4.20	
F	S	M	R										

銑刀片材質碼 MILLING INSERT GRADES

材質碼 Grade Type	塗層種類 Coating Type	特色 Features	加工特性 Application	加工材質 Work Material						產業應用範圍 Industry Area
				P	M	K	N	S	H	
CM6322 (金色)	PVD (物理)	<ul style="list-style-type: none"> 高耐磨性。 High wear resistance. 	<ul style="list-style-type: none"> 適合連續加工，精加工。 Continuous finishing cutting. 適合調質鋼，鑄鐵加工。 For hardened steel and cast iron. 	◎	◎	◎	-	○	◎	<ul style="list-style-type: none"> 模具產業。 Mold & die. 硬質零件。 Hardened parts. 航太零件。 Aircraft parts.
CM6223 (金色) 高階版 Upgrade				◎	◎	◎	-	◎	◎	
CM6332 (金色)	PVD (物理)	<ul style="list-style-type: none"> 耐磨性。 Wear resistance. 耐衝擊性。 Impact resistance. 	<ul style="list-style-type: none"> 適合中加工。 Medium finishing. 適合碳素鋼，合金鋼，不銹鋼，高溫合金加工。 For carbon steel, alloy steel, stainless steel and high temperature alloy. 	◎	◎	◎	-	○	○	<ul style="list-style-type: none"> 汽車零件。 Auto parts. 機械零件。 Machinery parts. 航太零件。 Aircraft parts.
CM6233 (金色) 高階版 Upgrade				◎	◎	◎	-	◎	◎	
CM6243 (金色)	PVD (物理)	<ul style="list-style-type: none"> 高耐衝擊性。 High impact resistance. 高韌性。 High toughness. 	<ul style="list-style-type: none"> 適合粗加工或斷續加工。 Roughing or interrupted cutting. 適合碳素鋼，合金鋼，不銹鋼，高溫合金加工。 For carbon steel, alloy steel, stainless steel and high temperature alloy. 	◎	◎	◎	-	◎	-	<ul style="list-style-type: none"> 汽車零件。 Auto parts. 機械零件。 Machinery parts. 航太零件。 Aircraft parts.

◎：第一推薦 First Recommend ○：第二推薦 Second Recommend -：不推薦 NO Recommend

銑刀桿 HIGH FEED MILLING CUTTERS

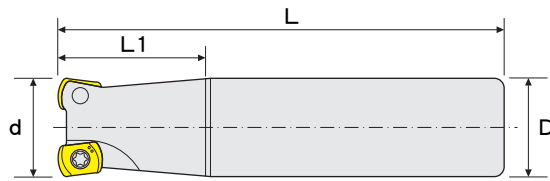

EBN



訂購編號 Order No.	尺寸 Dimensions (mm)				刀片 數量 Teeth	搭配刀片 Insert	Screw 	Wrench
	d	L1	L	D				
EBN06-02016-150L	16	30	150	16	2	BNMX0603..	TS3016	ETF08
EBN06-02016-200L	16	30	200	16	2			
EBN06-02017-150L	17	30	150	16	2			
EBN06-02017-200L	17	30	200	16	2			
EBN06-03020-150L	20	30	150	20	3			
EBN06-03020-200L	20	30	200	20	3			
EBN06-03021-150L	21	30	150	20	3			
EBN06-03021-200L	21	30	200	20	3			
EBN06-04025-150L	25	35	150	25	4			
EBN06-04025-200L	25	35	200	25	4			
EBN06-04026-150L	26	35	150	25	4			
EBN06-04026-200L	26	35	200	25	4			
EBN06-05032-150L	32	40	150	32	5			
EBN06-05032-200L	32	40	200	32	5			
EBN06-05033-150L	33	40	150	32	5			
EBN06-05033-200L	33	40	200	32	5			
EBN06-05035-150L	35	40	150	32	5			
EBN06-05035-200L	35	40	200	32	5			
EBN09-03025-150L	25	40	150	25	3	BNMX0904..	TS4009	ETF15
EBN09-03032-150L	32	40	150	32	3			

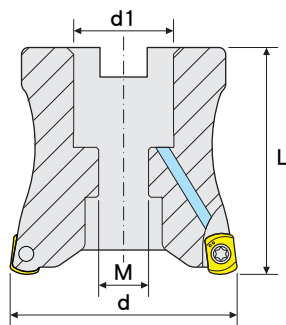

FBN

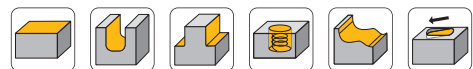

訂購編號 Order No.	尺寸 Dimensions (mm)				刀片 數量 Teeth	搭配刀片 Insert	Screw 	Wrench
	d	L	d1	M				
FBN06-07050-2200-C	50	50	22.00	-	7	BNMX0603..	MS2506E	ETF08
FBN06-07052-2200-C	52	50	22.00	-	7			
FBN09-06050-2200-C	50	50	22.00	-	6	BNMX0904..	TS3504	ETF15
FBN09-06052-2200-C	52	50	22.00	-	6		TS4009	
FBN09-07063-2200-C	63	50	22.00	-	7			
FBN09-07063-2700-C	63	50	27.00	-	7			
FBN09-07066-2700-C	66	50	27.00	-	7			
FBN09-08080-2700-C	80	50	27.00	-	8			
FBN09-10100-3200-C	100	50	32.00	-	10		TS3504	

※ 型號後端 -C 為出水孔設計。 Product number end in -C are coolant-through design.

銑刀桿 HIGH FEED MILLING CUTTERS

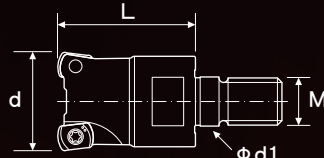

HBN



訂購編號 Order No.	尺寸 Dimensions (mm)				刀片 數量 Teeth	搭配刀片 Insert	Screw 	Wrench
	d	L	d1	M				
HBN06-02016	16	25	8.5	M8	2	BNMX0603..	TS3016	ETF08
HBN06-02017	17	25	8.5	M8	2			
HBN06-03020	20	30	10.5	M10	3			
HBN06-03021	21	30	10.5	M10	3			
HBN06-04025	25	35	12.5	M12	4			
HBN06-04026	26	35	12.5	M12	4			
HBN06-04032	32	40	17.0	M16	4			
HBN06-05032	32	40	17.0	M16	5			
HBN06-04035	35	43	17.0	M16	4			
HBN06-05035	35	43	17.0	M16	5			
HBN06-06040	40	43	17.0	M16	6			
HBN06-06042	42	43	17.0	M16	6			
HBN09-03025-C	25	35	12.5	M12	3	BNMX0904..	TS4009	ETF15
HBN09-04032-C	32	40	17.0	M16	4			
HBN09-04035-C	35	43	17.0	M16	4			
HBN09-05042-C	42	43	17.0	M16	5			

※ 型號後端 -C 為出水孔設計。 Product number end in -C are coolant-through design.

切削條件表 CUTTING CONDITION TABLE

加工材質 Material	碳素鋼 Carbon Steels	調質鋼 Hardened Steels	不銹鋼 Stainless Steels	鑄鐵 Cast Iron	高溫合金 High Temp Alloys
工件料號 Material Code	S35C,S45C,S50C	SKT,SKD	SUS304	FC,FCD	Ti-6Al-4V
硬度 Hardness	HRC<40	HRC40~55	—	HRC<30	HRC<30
切削速度 Vc	120~250m/min	50~120m/min	100~180m/min	120~250m/min	50~100m/min
每刃進給量 fz (mm)	0.3~1.6	0.3~1.0	0.3~1.2	0.3~1.6	0.3~0.8
加工深度 Ap (mm)	0.3~0.9	0.3~0.7	0.3~0.9	0.3~0.9	0.3~0.7
備註 Remarks	※ 面銑加工寬度(Ae)建議 = 外徑 < 80%。 Recommended cutting width(Ae) for face milling is less than 80% of diameter.				



※ 切削公式 / Cutting formula : S(主軸轉速) = Vc(切削速度) × 1000 / D(外徑) / π (3.14) F(進給速度) = fz(每刃進給量) × Z(刃數) × S(主軸轉速)

R 角編程設定 Programming- Corner R		
刀片 Insert	內接圓 R 角 Input. R	切削殘留量 Uncut
BNMX0603	2.0 mm	0.42 mm
BNMX0904	2.5 mm	0.61 mm

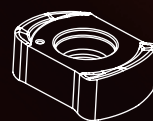

100% 台灣製造
MADE IN TAIWAN

景明精密工具有限公司

總公司: TEL/ +886-6-7940726

台北公司: TEL/ +886-2-29043033

廈門景力公司: TEL/ +002-86-5926-155335~7

信箱 Taiwan E-Mail: business@cmttools.com.tw