



GREAT TONG LING

www.great-tongling.com.tw





About Great Tong Ling

Great Tong Ling Enterprise Co., Ltd. (GTL) was established in Taichung city in April, 1982. With over 30 years of effort, our monthly revenue has grown to 1 million USD, and the employee number has increased from 2 to more than 70. GTL is one of the largest agent for mechanical parts in Taiwan. The key to such great development is that we found our niche between manufacturers and customers. Distinct from other distributors who only sell products passively according to customers' request, GTL incorporated technical support network all over Taiwan. We not only sell the product, we also offer immediate advice and solutions to our customers to ensure their production goes smoothly.

GTL sells almost all parts required in mechanical power transmission such as different types of motors (induction motors, stepless variable speed motors, inverter duty motors, servo motors, stepping motors), speed exchangers, gearboxes (cycloidal gearbox, planetary gearbox, worm gear reducer, parallel shaft gearbox), and all accessory parts for power transmission (torque limiters, cam clutches and brakes, couplings, chains). Moreover, we established a factory automation solution section 10 years ago. The section extends our service from power transmission to factory automation systems. We expanded our product range to motion controllers, programmable logic controllers, human machine interface, and various kinds of sensors. We provides factory automation solutions for our clients as well.

Our engineers support our customers with solid automation control know-how and programming skill. We know the system very well so we know exactly what you need. With more than 30 years of sales experience, GTL offers stable supply, proficient technical support, and competitive price.

If you are interested in products made in Taiwan, we are your best partner!
Let us be your connection to Taiwan!

Head Office

■ Taichung

No. 3, Lane 151, Chung Ming Rd.,
Taichung City, Taiwan
TEL:+886-4-23220225 FAX:+886-4-23222087
E-mail:gtlcom@ms38.hinet.net

Sales offices in Taiwan

■ Chiayi

No. 51, Lane 195, Ziqiang St., Chiayi City
TEL:+886-5-2362266-7 FAX:+886-5-2362268

■ Kaohsiung

No 32, Yichang St., Lingya Dist., Kaohsiung City
TEL: +886-7-7223282 FAX:+886-7-7512139

Branch in China

■ Kunshan Tungshin M/E C/L

No. 3220 W. Qiangjin Rd., Bacheng Town,
Kunshan City, China
TEL: +86-512-5780-6101-2 FAX: +86-512-5780-6162
E-mail:ksts3220@163.com

■ Tainan

No. 335, Chungshan Rd., Yongkang Dist., Tainan City
TEL:+886-6-2012733 FAX:+886-6-2016157

■ Hsinchu

TEL:+886-3-5830622 FAX:+886-3-5830738



TUNG SHIN ELECTRONICS

Tung Shin Torque Limiter is a protective device that limits the torque transmitted in a drive system by slipping when the torque transmitted exceeds a preset value as a result of shock loads, overloads, or machine jams. It automatically reengages when the overload is removed. No resetting is required. TUNG SHIN torque limiter prevents damage of the machine and the lost of stopping the machine operation.

FRICTION DISC TORQUE LIMITER



TUNG SHIN TORQUE LIMITER

- single nut regulation
- lock washer



TUNG SHIN TORQUE LIMITER

- 3 bolts regulation
- preset torque with 3 bolts



TUNG SHIN TORQUE LIMITER COUPLING TYPE

The torque limiter coupling combines overload slip protection with the ability to couple driving and driven shafts. It consists of a TUNG SHIN torque limiter and roller chain coupling. This construction provides a dependable and easy-to assemble flexible coupling.

TL250-1C

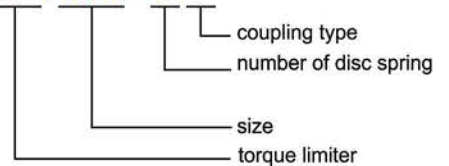

TUNG SHIN ONE(SINGLE) POSITION ENGAGEMENT BALL DETENT TORQUE LIMITERS



Characteristics:

1. AF series(flange type), AC series(coupling type)
2. roller and roller pocket combination
3. easy to adjust tripping torque
4. one(single) position engagement
5. backlash free transmission
6. precise torque limitation
7. single overload synchronously

TUNG SHIN TORQUE HOLDER



Characteristics:

1. longer service life: special friction composition is used to provide much longer service life than any other type of brake lining
2. stability of slipping torque: torque fluctuation is very limited. stable torque can be transferred.
3. accuracy of constant torque: even during peak status, stable torque is transferred consistently
4. plain bearing: special material is used to ensure longlasting wear
5. light weight: AF flange is made of aluminum
6. compact: unique design has resulted in significant space saving than other braking devices
7. easy torque setting: due to torque indication, torque setting is easy
8. maintenance free: lubrication oil and cooling are unnecessary
9. Non-Asbestos: friction material does not contain asbestos



TUNG SHIN ELECTRONICS-SCR STEPLESS SPEED EXCHANGER

SSM-

A type SCR stepless speed variable motor



SSM-

F type SCR stepless speed variable motor



SCR stepless speed exchanger



Characteristics:

1. speed variation range 10:1
2. activation torque > 200%
3. closed circuit control, the loading speed changing rate < 2%
4. especially suitable for high inertia and reversed loading
5. high tolerance of voltage oscillation

Comparison of SCR and other speed exchanger

1. The stability and reliability of speed control is much better than any speed exchanger without speed feedback loop. The stability of loading remains under 2% when the variation of loading is between 10%-100%.
2. The output torque remains extremely high at low speed. The operation is smooth within 10-times speed variation range from 140-1400 rpm.

Example: electronic speed exchanger 5HP/4P/600rpm = 2 kg-m

SCR 5HP/4P/600rpm = 2.52 kg-m

SDBC SMALL DYNAMIC BRAKE CONTROLLER



Characteristics:

1. no worry about the brake failure due to contamination of dust, iron scrap, and oil
2. prevent lost of stopping the machine for changing brake lining
3. no contact point - no sparkle, no delay
4. long lifetime
5. Brake time can be adjusted easily and be set according to the loading type.
6. simple installation, no need to change the motor structure
7. simple maintenance

DBC DYNAMIC BRAKE CONTROLLER



Characteristics:

1. an alternative for electric brake or clutch brake for normal application
 2. applicable for single/ three phase motors
 3. can be installed on any motors on a machine without considering the size issue
 4. support mechanical safety brake to prolong the lifetime of brake lining
 5. can connect to several motors with similar loading simultaneously
- The rated braking time per minute need to be limited according to the load inertia to prevent the motor temperature rise.



TUNG SHIN ELECTRONICS - synchronizing, ratio, and tension controller



MCA-AB

Characteristics

- 1. can work with several types of motor controller
- 2. three acceleraion/deceleration options
- 3. output short cut protection function
- 4. stable and precise output voltage
- 5. great tolerance of voltage oscillation

Application:

- 1. simultaneous acceleration control
- 2. simultaneous deceleration control
- 3. fast acceleration/deceleration control

dimensions

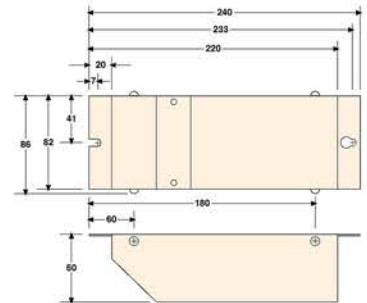

MCA-DB

Characteristics

- 1. can work with several types of motor controller
- 2. stand-by synchronizing function
- 3. pre-synchronizing function (voltage-relay)
- 4. output short cut protection function
- 5. stable and precise output voltage
- 6. great tolerance of voltage oscillation

Application:

- 1. synchronizing control
- 2. equal speed control
- 3. fixed linear speed operation control

dimensions

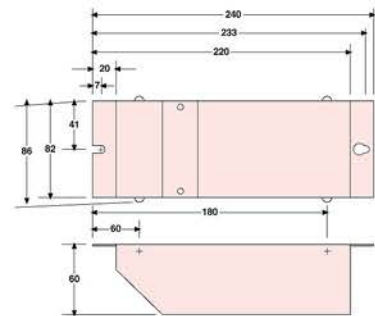

MCA-LB

Characteristics

- 1. can work with several types of motor controller
- 2. feedback from the generator
- 3. ratio integration control
- 4. output short cut protection function
- 5. stable and precise output voltage
- 6. great tolerance of voltage oscillation

Application:

- 1. roller feed and receive control
- 2. fixed linear speed operation control

dimensions

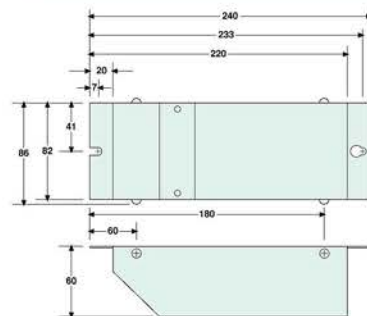

MCA-SB

Characteristics

- 1. can work with several types of motor controller
- 2. three acceleraion/deceleration options
- 3. output short cut protection function
- 4. stable and precise output voltage
- 5. great tolerance of voltage oscillation

Application:

- 1. synchronizing operation speed with certain ratio
- 2. current-voltage conversion
- 3. sensor-voltage conversion

dimensions

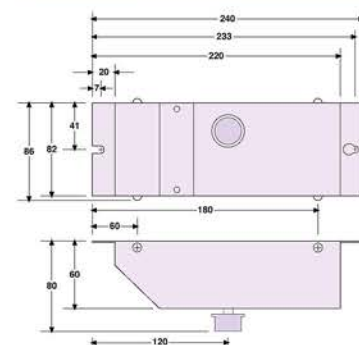



Worm Gearbox



Characteristics:

1. IEC and NEMA standard
2. ratio from 1:5 to 1:3600
3. motor power from 1/4HP to 100HP
4. high quality double-liseal
5. Worm gears all undergo hardening heat treatment and grinding at the gear teeth surface
6. The material of worm gears is ALBC3
7. The material of outer cases is high strength FC-20 gray casting iron
8. The input bearing is tapered roller bearing
9. designed for heavy loading industry; long lifetime



Gearbox



Characteristics:

1. Our gears are designed according to German standard (DIN) - high transmission efficiency, high strength, and low noise
2. Various installation types are available : vertical, horizontal, double shafts, and motor direct connection
3. The material of main body is gray casting iron which increases the toughness of the body. The material of gears is chromium-molybdenum steel and all gears are ground .
4. All gearboxes with ratio higher than 1:30 are 3-stages to improve the strength and lifetime .
5. The input pinion is supported with 2 bearings to ensure the stable operation.
6. The input flange can adapted to any motor with IEC or NEMA standard
7. The ratio range covers from 1/5 to 1/20
8. affordable motor power from 1/4HP to 75HP
9. Fine processing of all parts makes the operation more silent and increases the transmission efficiency
10. The body dimension and shaft size can adapt to SEW and Flender machines



S-series Helical + Worm Gear Reducer



Characteristics:

1. interchangeable with other international leading brands; compact structure and small size
2. The combination of high efficiency spiral gear and worm gear makes the operation smoother and quieter than gearboxes with only spiral gears.
3. The ratio covers a wider range (from 1:8-1:210) than worm gear only.
4. It can afford motor power from 1/4HP to 30HP, so various needs can be satisfied.
5. The gear and worm are made of 20CrMo carburizing steel and the worm gear is made of aluminum bronze, which enhances the tolerance of power transmission
6. Under certain condition, the power transmitting direction is not reversible (self-lock), securing the transmission.



Parallel Shaft Worm Gear Reducer (Alumium Case)

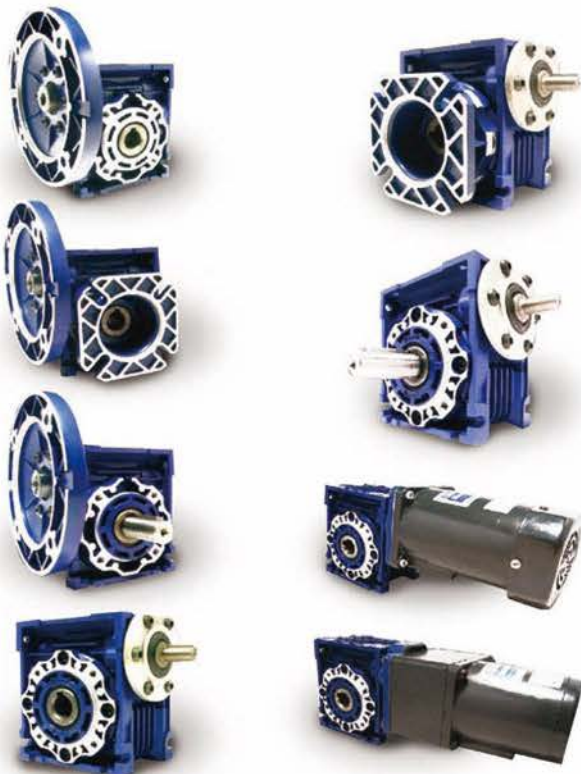

Characteristics:

1. The alumium case reduces the weight, and the main body undergo powder coating which prevents erosion. The dimensions and specifications are compatible with Motovario.
2. Small and compact structure design which lowers the installing space required.
3. high precision
4. clockwise and counterclockwise rotation
5. smooth and quiet operation
6. various accesories and simple installation
7. Light weight design: the gearbox can be hung on the equipment without increasing the load
8. The enlarged heat emission area makes the gearbox more durable
9. can be installed in all directions
10. The output hollow shaft can afford heavier load than normal cast iron
11. The material of worm gear is chromium-molybdenum steel with carburizing heat treatment and burnish at gear teeth.



K-series Helical-Bevel Gear Reducer



Characteristics:

1. interchangeable with other international leading brands; compact structure and small size
2. The combination of high efficiency helical gear and bevel gear set makes the power transmission efficiency higher than 90%.
3. The ratio covers a wider range (from 1:8-1:215) than worm gear only.
4. It can afford motor power from 1/4HP to 30HP, so various needs can be satisfied.
5. The helical gear and helical bevel gear are made of Chromium Molybdenum alloy steel with carburized treatment.
6. Provides 90 degree angle transmission similar to that of worm gear units to minimize space needed for installation.
7. All models are designed for various mounting position (M1~M6) specified by customers.
8. The reducers are designed with modern exterior while maintained high rigidity.



F-series Parallel Shaft Helical Gear Reducer



Characteristics:

1. interchangeable with other international leading brands; compact structure and small size
2. The combination of high efficiency helical gears makes the power transmission efficiency higher than 90%.
3. The ratio covers a wide range, from 1:4-1:245.
4. It can afford motor power from 1/4HP to 60HP, so various needs can be satisfied.
5. All helical gears are made of Chromium Molybdenum alloy steel with carburized treatment.
6. The parallel shaft orientation is designed to minimize the space needed for installation.
7. All models are designed for various mounting position (M1~M6) specified by customers.
8. The reducers are designed with modern exterior while maintained high rigidity.



SCREW LIFT



Brief introduction:

1. A screw lift is composed of main body with internal thread, a screw, and other accessories. It can lift from 1 to 50 tons.
2. The end of screw has several types: no end, threaded end, rod end, clevis end, top plate
3. A screw lift has characteristics of small size, multifunction, light weight, silent operation, compact structure, easy installation, flexible, high transmission efficiency, and long lifetime
4. One can use a screw lift solely or with combination of multiple units. The ascending and descending height can be precisely controlled with program. It can be driven by motors or manually.

PLANETARY GEARBOXES



Combined With Worm Gear



Combined With Servo Motor



Combined With Variator



Combined With Air Motor

Characteristics

1. small size, light weight
2. high efficiency
3. low backlash
4. high torque
5. high tolerance and durable



A-ONE SHAFT MOUNTED REDUCER



Characteristics

1. international dimensions and specifications, compatible with EU and USA dimensions
2. all gears are ground
3. has been exported to 15 countries
4. low backlash models (<math><6\text{ arcmin}</math>) can be used for servo motor
5. the output shaft is parallel to the motor for easy installation. No foot structure, and no need to align the shafts



TUNG SHIN Low Backlash Reducers For Servo Motors



SG series



SGR series



ST series



SD series



SGS
for precise gear rack



HK hollow rotary



NEW!
RV gear reducer



LUYANG - SMALL GEARED MOTORS





Couplings For Servo Motors

Charateristics

1. No counteracting force: perfectly absorbs shaft shift, angular displacement, and shaft-end displacement by elasticity.
2. high rigidity, high torque, high tolerance
3. maintenance-free, oil, and chemical-resistant
4. integrated design, simple installation
5. low inertia, no backlash
6. suitable for precise positioning power transmission of small servo motor
7. position displacement buffering and vibration proof



Various Motors



European Standard Motor

Charateristics

1. Adapt IEC international standard dimensions.
2. Protection level: IP55
3. Isolation level: F (temp.tolerance:155° C)
4. Temperature Raise level: B (80° C)



TECO high efficiency Motor

5. Installation B3 horizontal installation
B5/B14 Vertical installation
6. Wide voltage range: 50/60Hz, 220~240/380~460V
7. European certification "CE"Mark safety certification



Blower Machine



High Pressure Blower



Turbo Blower



Motor Dimension

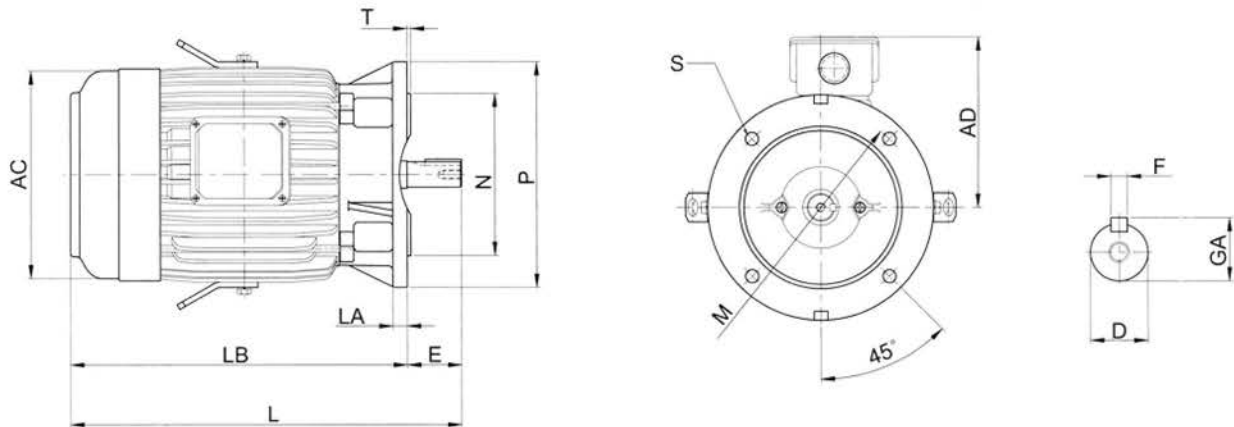

unit: mm

output (HP)			model	AC	AD	L	LA	LB	E	M	N	P	D	S	T	F	GA
2P	4P	6P															
0.25	0.25	—	63	144	123	248.0	12	225.0	23	130	110	160	11	10.0	3.5	4	12.5
0.5	0.5	—	71	162	133	277.5	12	247.5	30	130	110	160	14	10.0	3.5	5	16.0
1	1	0.5	80	177	144	282.0	12	242.0	40	165	130	200	19	12.0	3.5	6	21.5
2, 3	2	1	90L	200	157	371.5	12	321.5	50	165	130	200	24	12.0	3.5	8	27.0
—	3	2	100L	219	180	374.5	16	314.5	60	215	180	250	28	14.5	4.0	8	31.0
5	5	3	112M	235	189	431.0	16	371.0	60	215	180	250	28	14.5	4.0	8	31.0
7.5, 10	7.5	5	132S	273	224	454.0	20	374.0	80	265	230	300	38	14.5	4.0	10	41.0
—	10	7.5	132M			492.0		412.0									
15, 20	15	10	160M	334	263	608	20	498	110	300	250	350	42	18.5	5.0	12	45.0
25	20	15	160L			652		542									
30	—	—	180MA	382	305	672	20	562	110	350	300	400	48	18.5	5.0	14	51.5
—	25, 30	20	180MC			672		562									
40	—	—	180LA	382	305	710	20	600	110	350	300	400	55	18.5	5.0	16	59.0
—	40	25, 30	180LC			710		600									
50, 60	—	—	200LA	420	342	770	20	660	110	400	350	450	55	18.5	5.0	16	59.0
—	50, 60	40, 50	200LC			800		140					60				
75	—	—	225SA	458	386	786.0	22	676.0	110	500	450	550	55	18.5	5.0	16	59.0
—	75	60	225SC			816.0		140					65				
100	—	—	250SA	510	479	890.5	22	780.5	110	500	450	550	55	18.5	5.0	16	59.0
—	100	75	250SC			920.5		140					75				
125	—	—	250MA	510	479	947.5	22	837.5	110	500	450	550	55	18.5	5.0	16	59.0
—	125	100	250MC			977.5		140					75				



Tung Shin Gearboxes

Table for Model Selection

Power	Ratio	1/4~1/10	1/11~1/20	1/21~1/30	1/31~1/60	1/61~1/120	1/120~1/200
		4P	6P				
1/4		1	1	1	1	1	1
1/2	1/4	1	1	1	1	1	3
1	1/2	2	2	2	2	3	4
2	1	2	2	3	3	4	5
3	2	4	4	4	4	5	6
5	3	4	4	5	5	6	7
7 1/2	5	6	6	6	6	7	8
10	7 1/2	6	6	7	7	8	9
15	10	7	7	8	8	9	
20	15	7	8	8	8		
30	20	8	9	9	10		
40	30	9	9	10	10		
50	40	10	10				

©Selection of Disco speed variator: 1/4HP~1/2 HP -- 4P frame number; 1HP~7 1/2 HP-- 6P frame number

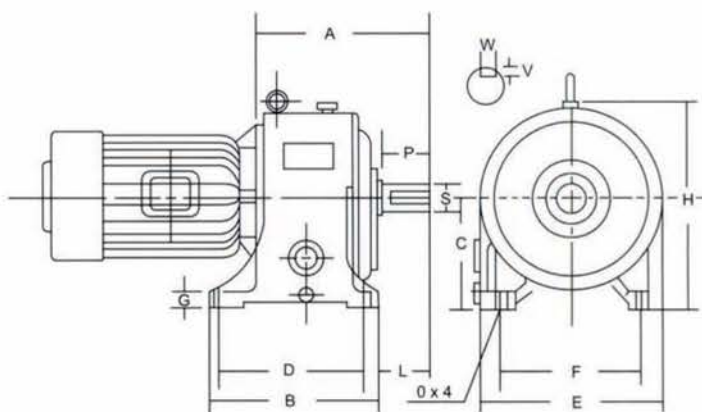

Dimension

unit:mm

Model	A	B	C	D	E	F	G	H	L	O	S	P	WxV
TYH-1	170	150	95	120	170	130	12	175	45	10	25	45	7x4
TYH-2	205	190	110	160	200	150	15	210	50	12	30	50	7x4
TYH-3	240	220	125	180	230	190	18	230	60	15	35	60	10x4.5
TYH-4	265	250	140	210	260	200	20	265	65	15	40	65	10x4.5
TYH-5	290	270	160	230	280	210	25	285	70	15	45	70	12x4.5
TYH-6	330	310	180	265	320	240	25	330	75	19	50	75	12x4.5
TYH-7	390	380	210	320	360	270	30	375	90	19	60	90	15x5.5
TYH-8	470	420	260	360	440	340	35	460	110	22	70	110	20x8



Tung Shin Gearboxes

TYV Type: 2-stage Vertical Gearbox

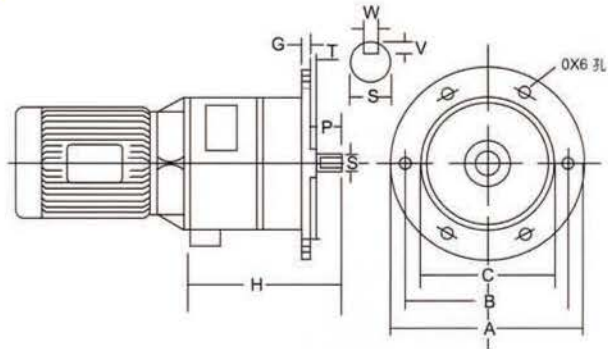

Dimension (mm)

model	H	A	B	C	T	G	O	S	P	WxV
TYV-1	170	200	180	160	4	10	10	25	45	7x4
TYV-2	205	240	215	190	4	12	12	30	50	7x4
TYV-3	240	260	235	210	4	12	15	35	60	10x4.5
TYV-4	265	300	270	240	5	16	15	40	65	10x4.5
TYV-5	290	340	300	260	5	16	15	45	70	12x4.5
TYV-6	330	380	340	300	5	18	19	50	75	12x4.5
TYV-7	390	420	380	340	5	20	19	60	90	15x4.5

TYHD Type: 2-shafts Horizontal Gearbox

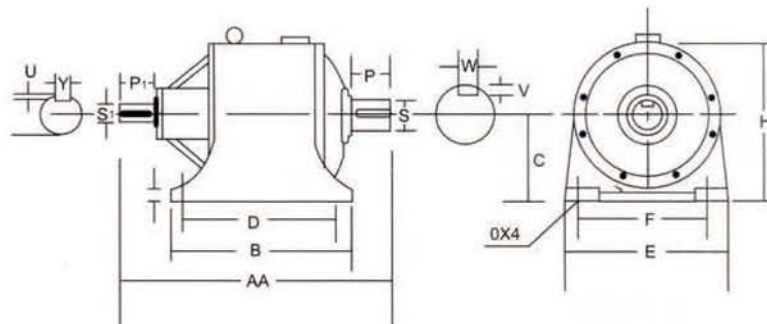

Dimension (mm)

model	A	B	C	D	E	F	G	H	L	O	S	P	WxV	S ₁	P ₁	YxU
TYHD-1	270	150	95	120	170	130	12	175	45	10	25	45	7x4	14	30	5x3
TYHD-2	325	190	110	160	200	150	15	210	50	12	30	50	7x4	19	40	5x3
TYHD-3	360	220	125	180	230	190	18	230	60	15	35	60	10x4.5	19	40	5x3
TYHD-4	415	250	140	210	260	200	20	265	65	15	40	65	10x4.5	24	50	7x4
TYHD-5	445	270	160	230	280	210	25	285	70	15	45	70	12x4.5	28	55	7x4
TYHD-6	510	310	180	265	320	240	25	330	75	19	50	75	12x4.5	32	60	10x4.5
TYHD-7	580	380	210	320	360	270	30	375	90	19	60	90	15x4.5	38	65	10x4.5
TYHD-8	660	420	260	360	440	340	35	460	110	22	70	110	20x8	48	70	12x4.5



Tung Shin Gearboxes

TYL Type 2-stage Horizontal Gearbox



Model

Power	Ratio		1/201	1/601	1/1201
	4P	6P	1/600	1/1200	1/6000
1/4			201	301	401
1/2	1/4		301	401	501
1	1/2		402	503	603
2	1		503	604	704
3	2		604	705	805
5	3		705	806	806

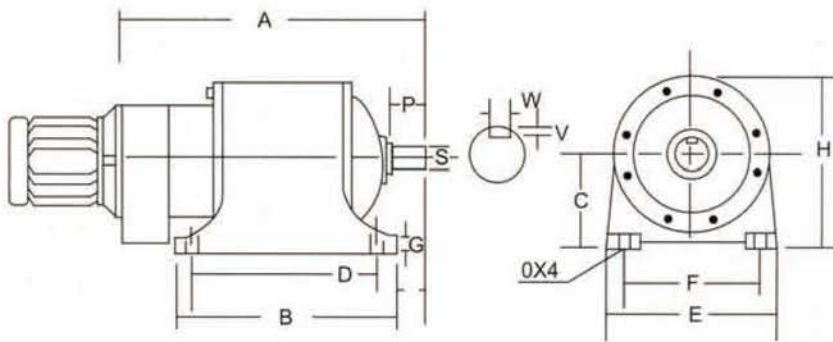

Dimension (mm)

model	A	B	C	D	E	F	G	H	L	O	S	P	WxV
TYL-201	330	190	110	160	200	150	15	210	50	12	30	50	7 x 4
TYL-301	365	220	125	180	230	190	18	230	60	15	35	60	10x4.5
TYL-401	390	250	140	210	260	200	20	265	65	15	40	65	10x4.5
TYL-402	420	250	140	210	260	200	20	265	65	15	40	65	10x4.5
TYL-501	415	270	160	230	280	210	25	285	70	15	45	70	12x4.5
TYL-502	470	270	160	230	280	210	25	285	70	15	45	70	12x4.5
TYL-603	510	310	180	265	320	240	25	330	75	19	50	75	12x4.5
TYL-604	530	310	180	265	320	240	25	330	75	19	50	75	12x4.5
TYL-704	590	380	210	320	360	270	30	375	90	19	60	90	15x5.5
TYL-705	610	380	210	320	360	270	30	375	90	19	60	90	15x5.5
TYL-805	690	420	260	360	440	340	35	460	110	22	70	110	20x8
TYL-506	725	420	260	360	440	340	35	460	110	22	70	110	20x8



TYCO Chain

TYC SLB Chain

- frequent change of chains due to fast abrasion of the chains?
- imperfect positioning due to fast abrasion of the chains?
- the chain lubricating oil contaminates the items carried by the chain?

TYC self-lubricate-bushing chain is the solution to all the problems!

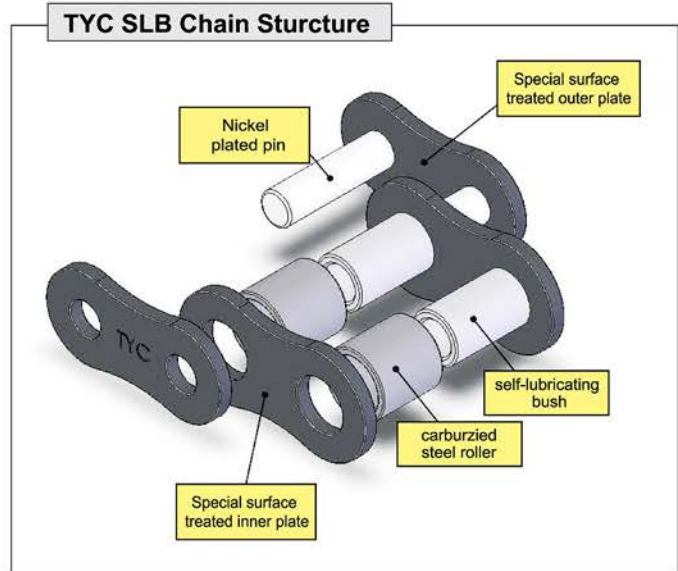

TYC T-Chain

- worldwide class of chains for oil drilling
- Trenchended chain is better than super chain
- suitable for equipment carrying extremely heavy load with chains

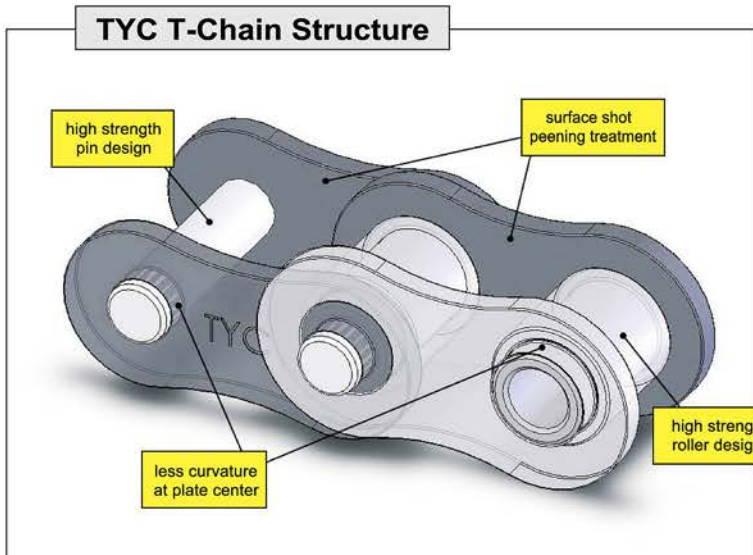

suitable for equipment carrying extremely heavy load with chains



Tong Ling DISCO Variable Speed Drive

Characteristics

1. High torque at low speed, highly efficient power transmission

The input capacity of Tong Ling DISCO variable speed drive ranges from 0.2kw~7.5kw. The torque is transmitted by several sets of helical planetary gear; hence it tolerates special tasks such as overload, shock loading, and counteract loading. At low speed, the planetary gear radius increases, which increases torque efficiently via larger arm of force.

2. Completely enclosed structure

DISCO variable speed drive alters speed mechanically in completely enclosed frame, so it can adapt to special environments, such as explosive, flammable, dusty, humid, and acidic/basic environment. As long as an appropriate motor is selected, the DISCO variable speed drive can last very long.

3. The speed variation rate is within 0.01%

Another characteristic of mechanical speed variation is the stable speed. The planetary gear sets have pressure regulation device, and therefore the speed doesn't change due to temperature change or being used for too long.

4. Simple operation of speed variation

The speed can be changed with the adjusting wheel easily. With load or not, under operation the speed can be changed rapidly and precisely. Furthermore, it can be controlled with various remote control devices and PLC automatic control.



standard model

MODEL		ratio	variation range	speed (rpm)		output shaft torque (Kgf-m)		overload (Kgf)	
integrated with motor	double shafts			50Hz	60Hz	input shaft speed < 1500rpm	input shaft speed 1500~1800rpm	input	output
DK001AM	DK001A	1:6	1/8.4 ~ 1/1.4	165 ~ 1000	200 ~ 1200	0.15~0.078	0.13~0.065	30	40
DK002AM	DK002A					0.30~0.156	0.25~0.130	30	40
DK004AM	DK004A					0.60~0.312	0.50~0.260	40	60
DK007AM	DK007A					1.20~0.60	1.00~0.50	50	100
DK015AM	DK015A					2.40~1.20	2.00~1.00	75	130
DK022AM	DK022A					3.60~1.76	3.00~1.47	150	190
DK037AM	DK037A	1:6	1/8.4 ~ 1/1.4	165 ~ 1000	200 ~ 1200	6.00~2.96	5.00~2.47	150	190
DK055AM	DK055A					9.00~4.40	7.50~3.67	175	220
DK075AM	DK075A					12.0~6.00	10.0~5.00	175	220

with R-type reducer (ratio: 1/2.5 and 1/5)

R-type reducer ratio	MODEL		ratio	variation range	speed (rpm)		output shaft torque (Kgf-m)		overload (Kgf)	
	integrated with motor	double shafts			50Hz	60Hz	input shaft speed < 1500rpm	input shaft speed 1500~1800rpm	input	output
1/2.5	DK002AM R2.5	DK002A R2.5	1:6	1/21 ~ 1/3.5	66 ~ 400	80 ~ 480	0.713~0.371	0.594~0.309	30	70
	DK004AM R2.5	DK004A R2.5					1.43~0.741	1.19~0.618	40	110
	DK007AM R2.5	DK007A R2.5					2.85~1.43	2.38~1.19	50	170
	DK015AM R2.5	DK015A R2.5					5.70~2.85	4.75~2.38	75	330
	DK022AM R2.5	DK022A R2.5					8.55~4.18	7.13~3.49	150	480
	DK037AM R2.5	DK037A R2.5					14.3~7.03	11.9~5.87	150	480
1/5	DK055AM R2.5	DK055A R2.5	1:6	1/42 ~ 1/7	33 ~ 200	40 ~ 240	21.4~10.5	17.8~8.72	175	650
	DK075AM R2.5	DK075A R2.5					28.5~14.3	23.8~11.9	175	650
	DK002AM R 5	DK002A R 5					1.43~0.741	1.19~0.618	30	70
	DK004AM R 5	DK004A R 5					2.85~1.48	2.38~1.24	40	110
	DK007AM R 5	DK007A R 5					5.70~2.85	4.75~2.38	50	170
	DK015AM R 5	DK015A R 5					11.4~5.70	9.50~4.75	75	330
1/5	DK022AM R 5	DK022A R 5	1:6	1/42 ~ 1/7	33 ~ 200	40 ~ 240	17.1~8.36	14.3~6.98	150	480
	DK037AM R 5	DK037A R 5					28.5~14.1	23.8~11.8	150	480
	DK055AM R 5	DK055A R 5					42.8~20.9	35.6~17.4	175	650
DK075AM R 5	DK075A R 5	57.0~28.5	47.5~23.8	175	650					



Tong Ling DISCO Stepless Speed Exchanger Dimensions

D002A(4M)~D075A(4M)

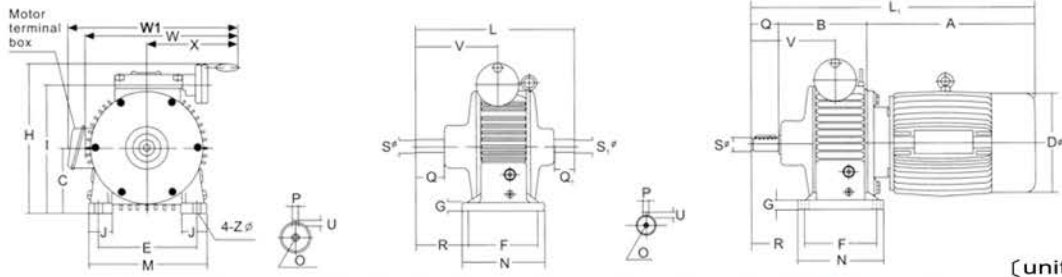

TYPE	A	B	C	D	E	F	G	H	I	J	L	L ₁	M	N	O	O ₁	P	P ₁	Q	Q ₁	R	S _(n6)	S _{1(n6)}	U	U ₁	V	W	W ₁	X	Z
D002A(4M)	187	100	71	137	110	105	12	188	148	25	195	317	140	125	M5	M5	5	5	30	25	48	14	14	5	5	99	191	---	121	9
D004A(4M)	210	115	90	150	120	105	15	218	177	32	221	355	160	135	M5	M5	5	5	30	30	59	14	14	5	5	109	234	280	149	10
D007A(4M)	227	137	106	170	160	125	15	249	208	38	243	424	186	150	M6	M6	6	6	40	30	75	20	19	6	6	129	266	307	166	12
D015A(4M)	288	173	125	196	180	140	18	313	246	48	314	511	225	165	M6	M6	8	8	50	40	100	25	24	7	7	157	311	341	190	12
D022A(4M)	315	208	150	196	245	230	20	378	298	53	387	583	294	270	M8	M8	8	8	60	50	85	30	28	7	7	187	370	378	220	14
D037A(4M)	355	208	150	226	245	230	20	378	298	53	398	623	294	270	M8	M8	8	8	60	50	85	30	28	7	7	187	370	391	220	14
D055A(4M)	405	249	200	284	315	250	30	475	389	70	467	724	365	290	M10	M10	10	10	70	60	103	35	32	8	8	211	435	461	250	18
D075A(4M)	445	249	200	284	315	250	30	475	389	70	467	764	365	290	M10	M10	10	10	70	60	103	35	32	8	8	211	435	461	250	18

D002A(4M)~D075A(4M)

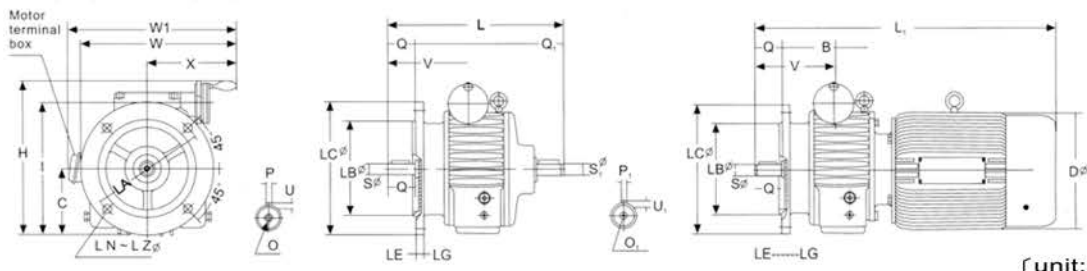

TYPE	B	C	D	H	I	L	L ₁	LA	LB	LC	LE	LG	LN	LZ	O	O ₁	P	P ₁	Q	Q ₁	R	S _(n6)	S _{1(n6)}	U	U ₁	V	W	W ₁	X
D002F(4M)	100	66	137	182	142	195	327	130	110	160	35	10	4	10	M5	M5	4	5	30	25	11	14	4	5	99	201	---	121	
D004F(4M)	115	87	150	215	174	221	385	130	110	160	35	10	4	10	M5	M5	5	5	30	30	14	14	5	5	110	249	280	149	
D007F(4M)	137	103	170	246	205	243	420	165	130	220	24	12	4	12	M6	M6	6	6	40	30	19	19	6	6	129	266	307	166	
D015F(4M)	173	120	196	308	241	314	531	165	130	220	4	12	4	12	M6	M6	8	8	50	40	24	24	7	7	157	315	341	190	
D022F(4M)	208	147	196	375	295	387	583	215	180	250	4	15	4	15	M8	M8	8	8	60	50	28	28	7	7	187	370	378	220	
D037F(4M)	208	147	226	375	295	398	623	215	180	250	4	15	4	15	M8	M8	8	8	60	50	28	28	7	7	187	370	391	220	
D055F(4M)	249	184	284	459	373	467	724	265	230	300	5	15	4	15	M10	M10	10	10	70	60	38	32	8	8	211	425	461	250	
D075F(4M)	249	184	284	459	373	467	764	265	230	300	5	15	4	15	M10	M10	10	10	70	60	38	32	8	8	211	425	461	250	

D002A(4M) R5 R2.5

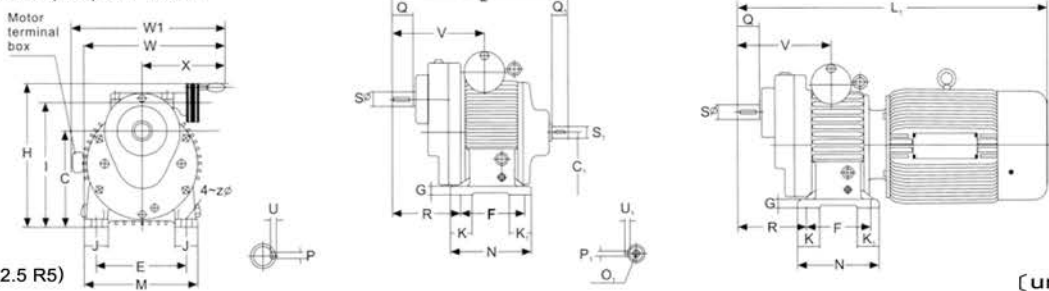

TYPE	C	C ₁	E	F	G	H	I	J	K	K ₁	L	L ₁	M	N	O ₁	P	P ₁	Q	Q ₁	R	S _(n6)	S _{1(n6)}	U	U ₁	V	W	W ₁	X	Z
D002A(4M)	116	71	110	105	12	188	148	25	25	25	234	356	140	125	M5	6	5	30	25	87	20	14	6	5	138	191	---	121	9
D004A(4M)	135	90	120	105	15	218	177	32	30	30	247	420	160	135	M5	6	5	30	30	84	20	14	6	5	134	229	280	149	10
D007A(4M)	160	106	160	125	15	249	208	40	40	40	272	433	190	150	M6	7	6	35	30	104	25	19	7	6	158	256	307	166	12
D015A(4M)	190	125	180	140	18	313	246	50	45	45	336	534	230	165	M6	8	8	45	40	123	30	24	7	7	180	305	341	190	12
D022A(4M)	224	150	245	230	20	378	298	55	50	50	425	621	300	270	M8	10	8	60	50	123	40	28	8	7	225	370	391	220	14
D037A(4M)	224	150	245	230	20	378	298	55	50	50	435	661	300	270	M8	10	8	60	50	123	40	28	8	7	225	370	391	220	14



GREAT TONG LING

Sales Office in Taiwan

■ Taichung (Head Office)

No.3, Lane 151, Chung Ming Rd., Taichung City, Taiwan
TEL: +886-4-23220225 FAX: +886-4-23222087
E-mail: gtlcom@ms38.hinet.net
tongling0716@gmail.com

■ Chiayi

No.51, Lane 195, Ziqiang St., Chiayi City
TEL: +886-5-2362266-7 FAX: 886-5-2362268

■ Kaohsiung

No.32, Yichang St., Linya Sidt., Kaohsiung City
TEL: +886-7-7223282 FAX: +886-7-7512139

■ Tainan

No.335, Chungshan Rd., Yongkang Dist., Tainan City
TEL: +886-6-2012733 FAX: +886-6-2016157

■ Hsinchu

TEL: +886-3-5830622 FAX: +886-3-5830738

Branch in China

■ Kunshan Tungshin M/E. C/L

No. 3220 W. Qiangjin Rd., Bacheng Town,
Kunshan City, China
TEL: +86-512-5780-6101-2 FAX: +86-512-5780-6162
E-mail: ksts3220@163.com
